

6-Pack LED Hide-A-Blast™



HB6PAK

Standard Black Bezel



Optional Chrome Bezel: 6PKBZCHM

Easy installation. No install screws needed, just pop it in a 1 inch mounting hole.

DESIGN FEATURES

- 6 LEDs in polycarbonate clear lens
- 20 flash patterns (19 flashing, 1 off pattern)

- Multiple Hide-A-Blast lights can be connected together and operated from the same control switch
- 15 foot cable

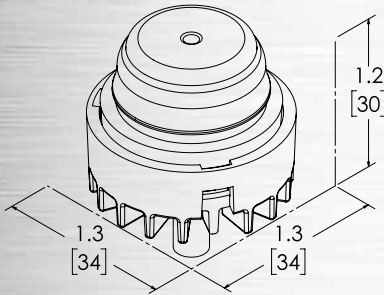

SPECIFICATIONS

- Lighthead 0.984" D x 0.591" H (25 mm x 15 mm) to the top of the lighthead base, overall 1.181" H (30 mm)
- Lighthead base is 1.366" D (35 mm)
- Controller module 1.035" W x 5.597" L x 0.579" H (26 x 142 x 15 mm)
- 12/24VDC
- 1.05 average amp draw
- 13.5 average watts

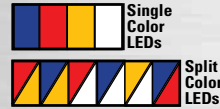

Twist Lock 6-Pack LED Hide-A-Blast™

DESIGN FEATURES

- Designed to work with the Ford Factory Prep Option (PI Utility 2016+ Tail Light Assembly) 86T
- Designed to work with the Ford Factory Prep Option (PI Utility 2011-14 Headlight Assembly) 86P
- Designed to work with the Ford Factory Prep Option (PI Sedan Headlight Assembly) 13P
- Rubber gasket eliminates water ingress



Twist Lock 6 Pack LED Hide-A-Blast for Ford Police Interceptor Sedan Head Light, PI Utility (2016+) Tail Light and PI Utility (2012-2014) Headlight

